

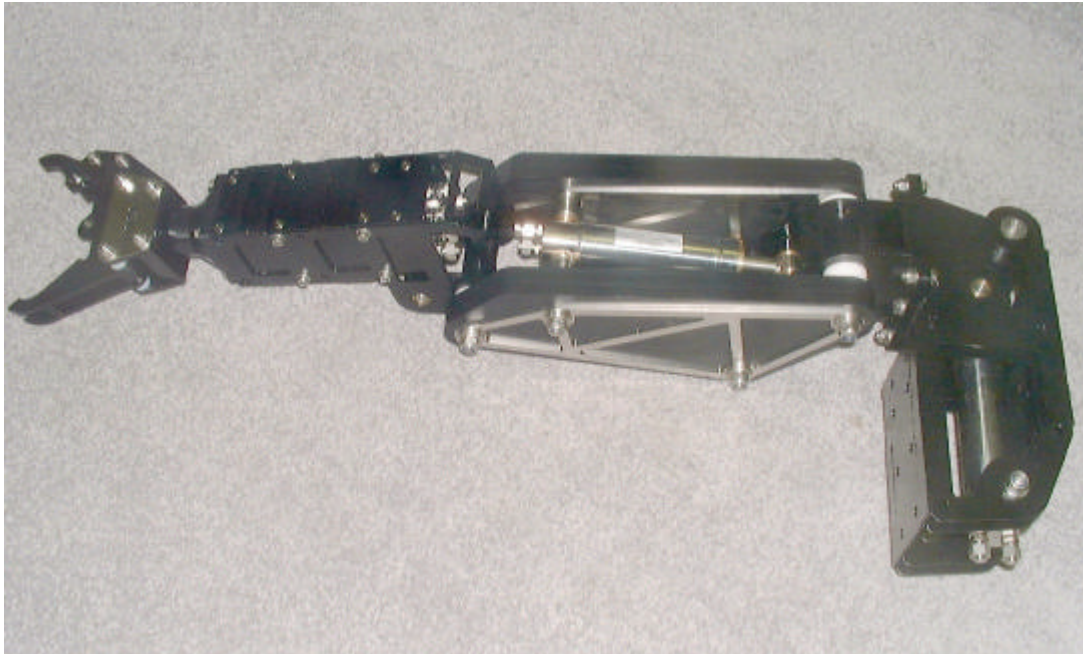

INNOVATIVE DESIGN ENGINEERING



HLK-RHD5 Manipulator:

The HLK-RHD5 Manipulator is a heavy duty, rugged five-function arm. It incorporates the HLK-2020 Continuous Jaw Rotate Mechanism which also has the unique 19mm diameter rope cutter. The arm incorporates a flange mounting to facilitate port or starboard mounting configurations on the slew plate. The slew plate is designed to enable the arm to swing across the front of the vehicle and also 30° to the outside. The arm also uses the larger HLK-13020 Hydraulic Cylinders to give additional lifting capability.

Specification:

Dimensions	Length of arm	943mm
	Length of slew plate	320mm
	Height (Stowed)	515mm
	Width	200mm
Capacities	Rotate	360° continuous
	Torque at 140 bar (across ports)	38Nm
	Lift capacity at full reach at 160 bar	80Kg
	Max working pressure	210 bar
Weight	Weight in air	30Kg
	Weight in water	20Kg
Construction	316 SS Epoxy hard coated	
	HE 30 Hard anodised aluminium	
	High Density Polyethelene	
Ports	1/8NPT / 7/16 S.A.E	

Hydro-Lek Ltd. Unit 4 Weller Drive Hogwood Lane Ind. Estate Finchampstead Berks U.K. RG40 4QZ
Telephone: +44(0) 1189 736903 Fax: +44(0) 1189 736915
Website: <http://www.hydro-lek.com> Email: enquiries@hydro-lek.com

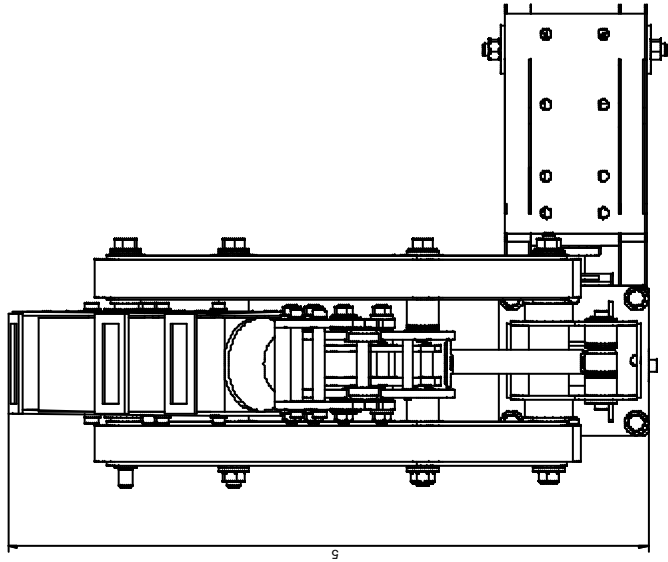
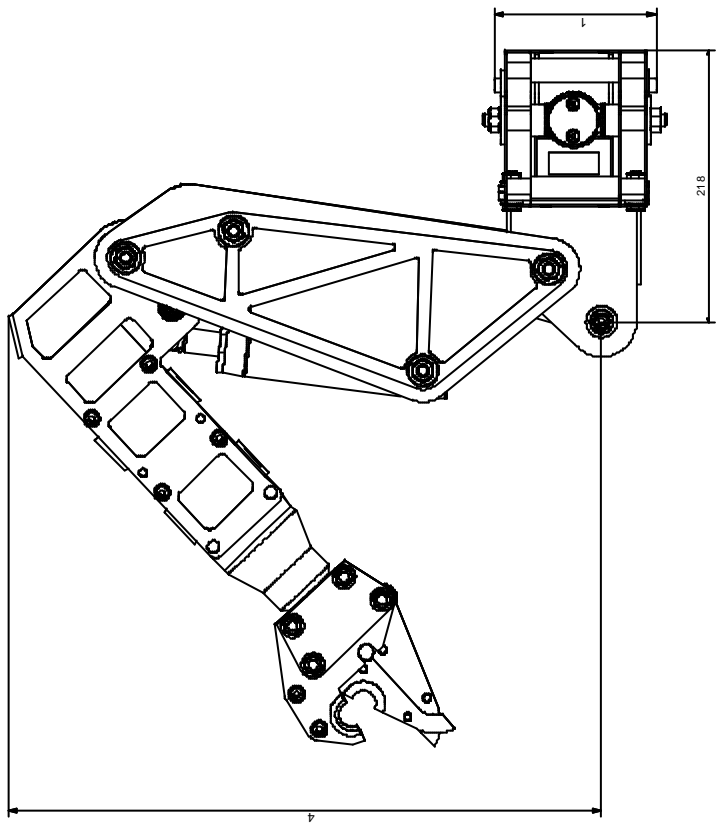
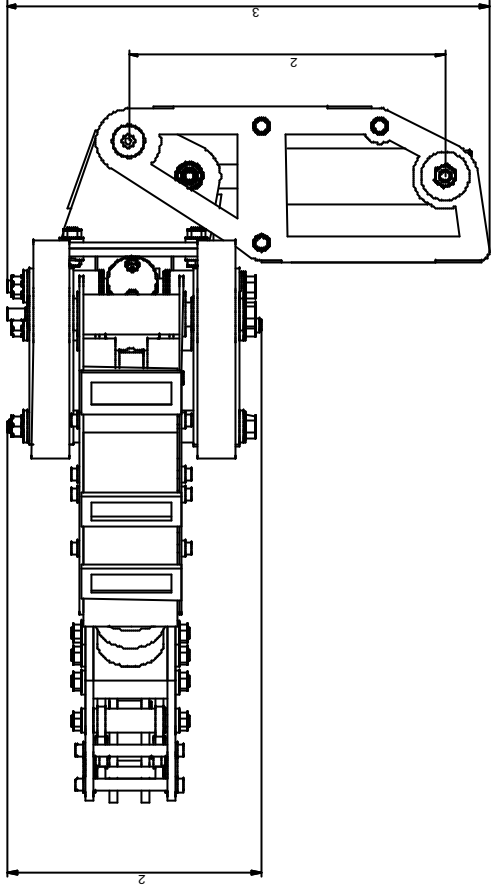

SPECIFICATION

LENGTH OF ARM (OPEN) 943 MM (FROM SLEW)

LENGTH OF SLEW PLATE 320 MM

HEIGHT 515 MM

WIDTH 203 MM

CAPACITIES

ROTATE 360° CONTINUOUS

TORQUE AT 140 BAR 38Nm

LIFT CAPACITY AT FULL REACH 80Kg @ 160 BAR

MAX WORKING PRESSURE 210 BAR

WEIGHT IN AIR 30.0 Kg

WEIGHT IN WATER 20.0 Kg

CONSTRUCTION

316 SS EPOXY HARD ANODISED ALUMINIUM

HIGH DENSITY POLYETHYLENE

PORTS:

1/8" NPT / 7/16" SAE