



HYDRO-LEK

REMOTE HANDLING SPECIALISTS



HLK-46000 Camera Boom Arm With Mini Pan & Tilt:

The HLK-46000 Camera Boom Arm has been designed for pipeline inspection work. Using a pair of these arms, pipelines of up to 1metre can be easily inspected. Its unique design allows the camera mount to stay at the same angle through the entire 135° of angular movement of the arm, without any adjustment. The camera mount can be tilted through a 90° and rotated through 180°. The arm uses Hydro-Lek's standard HLK-11060 hydraulic cylinders and HLK-2100 Mini Pan & Tilt.

Specification:

Dimensions	Length of arm (Extended)	1040 mm
	Height (Stowed)	636 mm
	Width	120 mm
Movement Range	Up / Down	65-0-70°
	Left / Right	0-30°
	(optional)	30-0-90°
	Camera Pan	180°
Weight	Tilt	90°
	Weight in air	13.7 Kg
	Weight in water	8.7 Kg
Construction	316 SS	
	HE 30 Hard Anodised Aluminium	

Specification & dimensions subject to change without prior notification

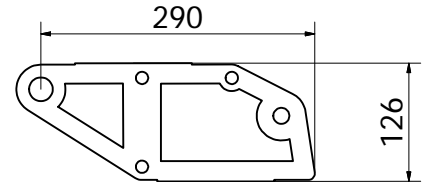
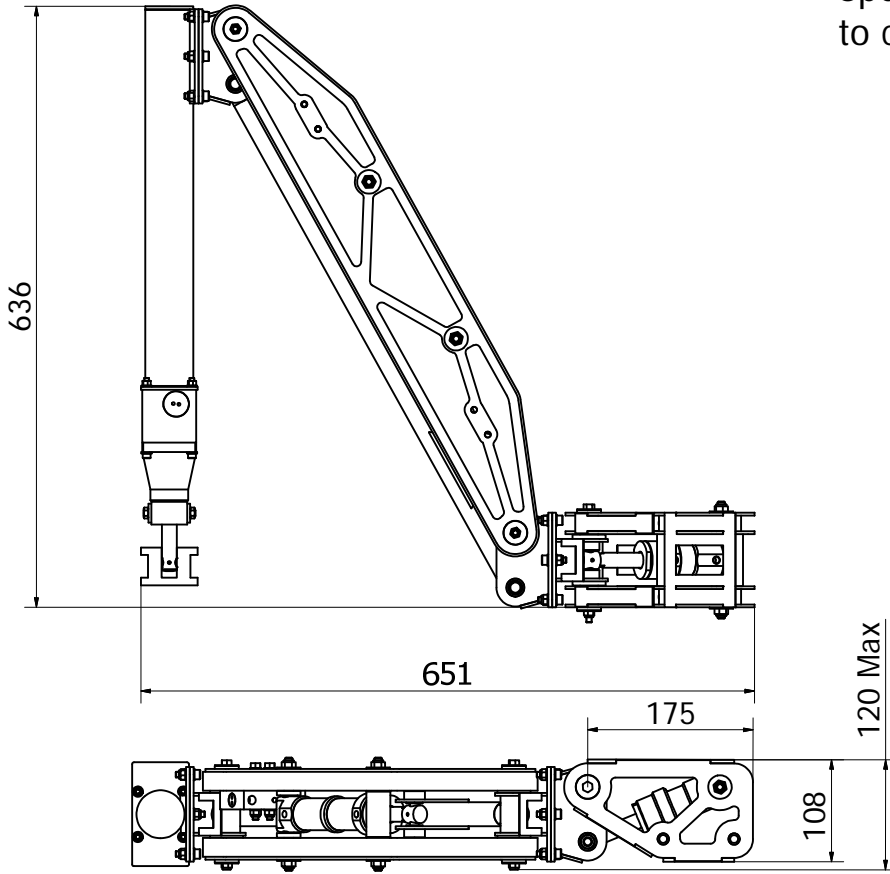

Alternative Slew Mount
from HLK-4600 Camera Boom Arm

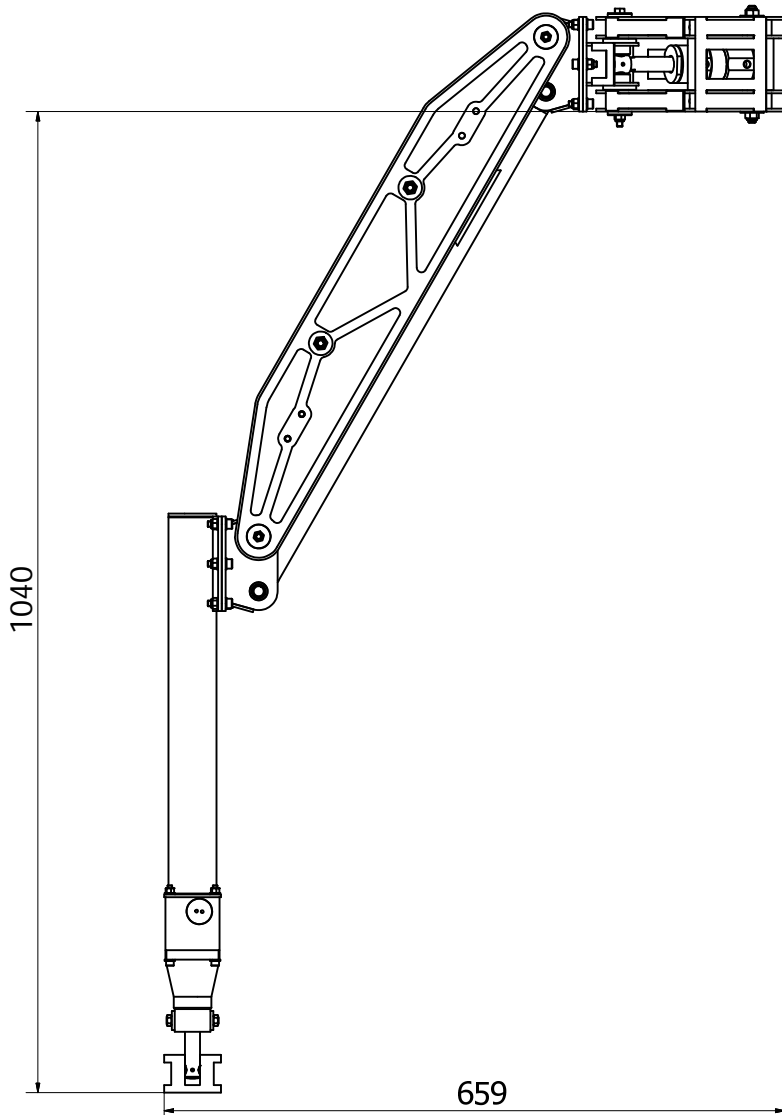

Specification

Movement Range

ARM	
Up-Down	65° - 0 - 70°
Left - Right	0 - 30°

CAMERA	
Tilt	0 - 90°
Rotate	0 - 180°

Weight

In Air	13.7Kg
In Water	8.7Kg

Construction

316 Stainless Steel
Hard Black Anodised Aluminium
Polyethylene

Designed by Alan Green	Checked by	Approved by	Date 14/04/2009	Date
Hydro-Lek Limited, Falcon House Falcon Business Park, Ivanhoe Road Hogwood Lane Industrial Estate Finchampstead, Berks. RG40 4QQ Tel: 0118 9736903 Fax: 0118 9736915			Camera Boom Arm Geometry	
HLK-46000 (Geometry)			Edition 0	Sheet 1 / 1